

REFERENCE PARTS LISTING

Replacement parts may be ordered through your plumber or the local distributor. When ordering replacement parts, always have the following information ready:

1. Model, Serial and Product number
2. Type of gas
3. Item number
4. Parts description

- 1 Vent Termination Hood
- 2 Wall Plate
- 3 ***Vent Pipe
- 4 Cold Water Inlet Nipple/Diptube
- 6 T&P Valve
- 7 Gas Control Valve/Thermostat (Honeywell)
- 9 *Discharge Pipe
- 10 Drain Valve
- 11 Outer Gas Door
- 12 Manifold Door Assembly (behind outer door) (see Figure 3 & Figure 4) (see also **Figure 46 & Figure 47**)
- 13 *Floor Drain
- 14 *Metal Drain Pan

- 15 Flexible Manifold Tube (see Figure 3 & Figure 4) (see also **Figure 46 & Figure 47**)
- 22 Anode (under cap)
- 23 Hot Water Outlet Nipple (or Optional Nipple/Anode)
- 26 Air Inlet Snorkel
- 27 Air Tower
- 28 ***Airbox
- 29 *Thermal Expansion Tank (required for all closed systems)
- 30 Sheet Metal Burner (see Figure 3 & Figure 4) (see also **Figure 46 & Figure 47**)
- 31 Gas Orifice (see Figure 3 & Figure 4) (see also **Figure 46 & Figure 47**)
- 32 Gas Manifold (see Figure 3 & Figure 4) (see also **Figure 46 & Figure 47**)
- 33 Manifold Door Gasket (see Figure 3 & Figure 4) (see also **Figure 46 & Figure 47**)
- 34 Manifold Door (see Figure 3 & Figure 4) (see also **Figure 46 & Figure 47**)

- 35 Two Piece Grommet With Clip (see Figure 3 & Figure 4) (see also **Figure 46 & Figure 47**)
- 36 Viewport (see Figure 3 & Figure 4) (see also **Figure 46 & Figure 47**)
- 37 Flexible Manifold Tube (see Figure 3 & Figure 4) (see also **Figure 46 & Figure 47**)
- 38 Pilot (see Figure 3 & Figure 4) (see also **Figure 46 & Figure 47**)
- 39 Thermopile (see Figure 3 & Figure 4) (see also **Figure 46 & Figure 47**)
- 40 Pilot Shield (see Figure 3 & Figure 4) (see also **Figure 46 & Figure 47**)
- * Items not supplied with the water heater.
- *** During operation the vent pipe and airbox can get hot.

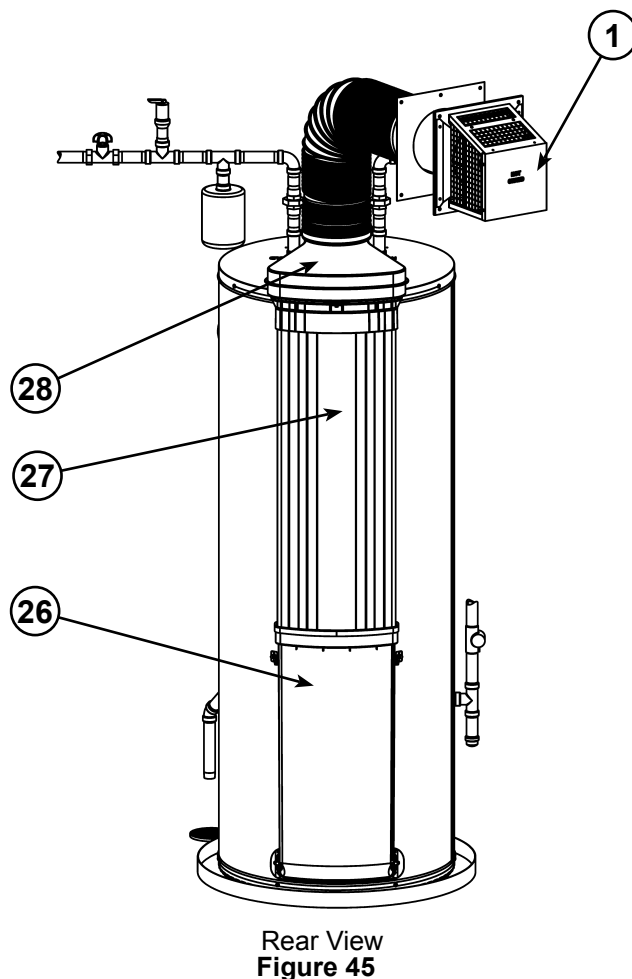
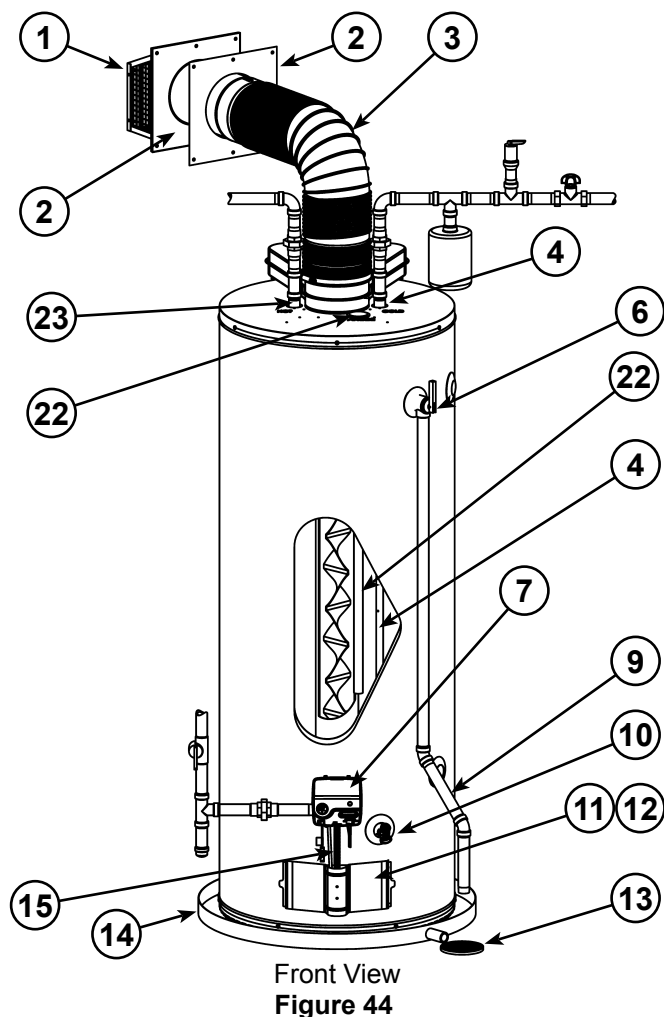

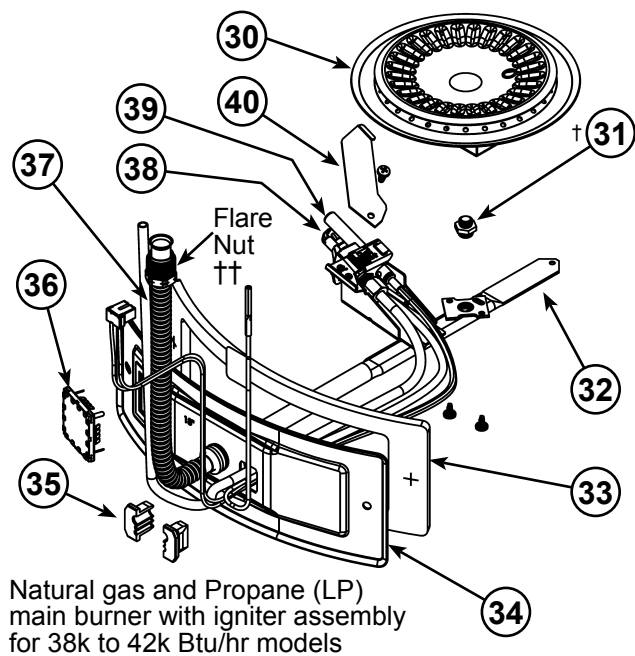

Figure 46

Natural gas and Propane
(LP) main burner with igniter
assembly for 47k Btu/hr
models

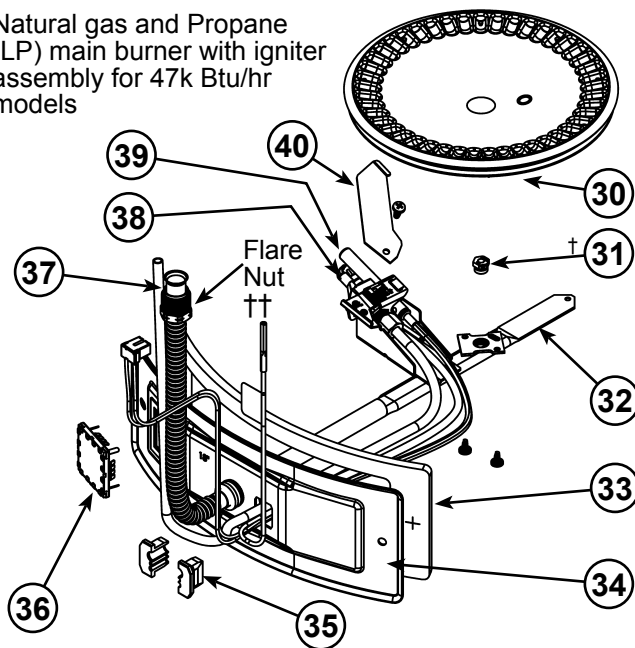

Figure 47

Notes:

† The orifice on Natural gas models has Right-hand thread, the orifice on Propane (LP) models has Left-hand thread.

†† For Natural gas models the Flare Nut has Right-hand thread. For Propane (LP) models the Flare Nut has Left-hand thread.